

FIXTURE TYPE: _____

PROJECT NAME: _____



SPECIFICATIONS:

CONSTRUCTION: Housing comprised of machined A319 aluminum casting. LED board protected with UV resistant molded PMMA optics and a silicone gasket.

ELECTRICAL: Powered by a remote Class P, 120-277VAC or 347-480VAC, 0-10V dimmable constant current driver. Luminaire is pre-wired with watertight 2 conductor 18 gauge SJEOOW whip. A 10kA surge suppression is standard with an optional 20kA surge suppressor. Operating temperature of -40°C to 50°C.

OPTICAL SYSTEM: LED boards have solderless connections for field upgradability. Available in CCT of 2700, 3000, 3500, and 4000K, >80 CRI. Optic available in Type II, IV, and V roadway distributions along with 20°, 60°, and 100° spot distributions. Consult factory for additional lumen output, CCT, and optical distribution options.

FINISHES: All exterior aluminum parts are polyester powder coat painted to meet AAMA-2604 standards. See Structura's finish options for available standard finishes. All hardware is 18-8 stainless steel with nickel plated brass cordgrip. [Care and Maintenance](#)

LISTINGS & RATINGS: Luminaire CSA listed according to CSA C22.2 No. 250.0-18/UL Standard 1598. Suitable for wet locations. LM-80 test reported L70 > 90,000 hours and calculated L70 > 110,000 hours.

WARRANTY: 5-year warranty on LED and drivers.



Metro mounted on Structura Bol pole.



Output			Type II ⁽¹⁾		Type IV ⁽¹⁾		Type V ⁽¹⁾		20° ⁽¹⁾	60° ⁽¹⁾	100° ⁽¹⁾
Callout	mA	Wattage	Lumen	Efficacy	Lumen	Efficacy	Lumen	Efficacy	Lumen	Lumen	Lumen
S019	188	13	1151	85.9	1118	83.4	1215	90.7	1220	1230	1219
S038	375	23	2096	91.9	2031	89.1	2213	97.1	2210	2233	2215
S056	560	31	3042	99.7	2947	96.6	3211	105.3	3206	3239	3213
S075	750	40	3987	99.4	3863	96.3	4209	104.7	4203	4246	4212
D038	375	23	2096	91.9	2031	89.1	2213	97.1	2210	2233	2215
D075	750	40	3987	99.4	3863	96.3	4209	105.0	4203	4246	4212
D112	1120	57	6084	106.7	5895	103.7	6423	112.7	6414	6479	6428
D150	1500	76	7974	104.9	7726	101.7	8418	110.8	8406	8492	8424

ORDERING GUIDE: EXAMPLE: METRO-S038-L30-2-UNV-C5-FIX-20-STD



1	Series	4	Distribution⁽⁴⁾	7	Mounting
METRO	Metro	2	Type II	FIX	Fixed
2	Output⁽²⁾	4	Type IV	ADJ	Adjustable
S019	Single 188mA	5	Type V	CAT/S	Catenary, Standalone
S038	Single 375mA	20	20° Spot	CAT/D	Catenary, Daisy Chain ⁽⁵⁾
S056	Single 560mA	60	60° Spot	J/RND	Junction Box, Round ⁽⁶⁾
S075	Single 750mA	100	100° Spot	J/RCT	Junction Box, Rectangular ⁽⁶⁾
D038	Dual 375mA	5	Voltage	8	Wire Length
D075	Dual 750mA	UNV	120-277V	10	10'
D112	Dual 1120mA	HIGH	347-480V	**	Specify
D150	Dual 1500mA	6	Metal Finish	9	Options
3	Color Temperature⁽³⁾	C*	See color options on finishes technical sheet	SS	20kA Surge Suppressor
L27	2700K	CSM	Custom Color	HSS	House-Side Shield ⁽⁷⁾
L30	3000K			10	Special
L35	3500K			STD	Standard
L40	4000K			MOD	Modified
AMB	Amber				

1. Lumen output based upon 3000K color temperature.
 2. Contact factory for alternative output options.
 3. Contact factory for other alternative temperature options.
 4. Contact factory for alternative distribution options.
 5. Daisy chain application with master and satellite control. Consult factory for application run distance.
 6. Junction box mounting includes adjustable knuckle.
 7. House-side shield available for roadway distribution only.

Single Module (S***)

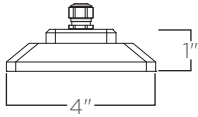

Dual Module (D***)

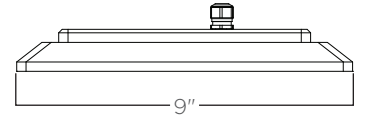
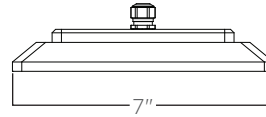

Weight: 2lbs
EPA:
 Face = 0.35ft²
 Side = 0.07ft²

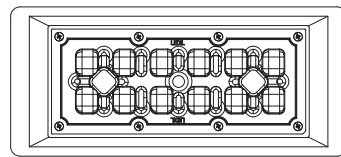

Weight: 4lbs
EPA:
 Face = 0.61ft²
 Side = 0.07ft²

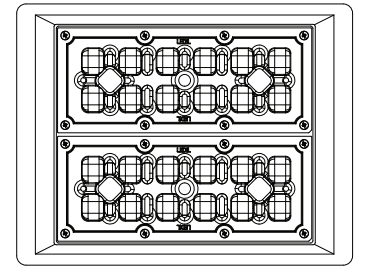

Fixed Mounting (FIX)

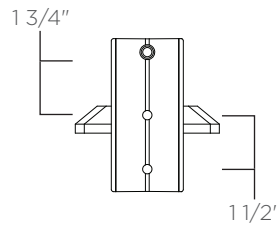
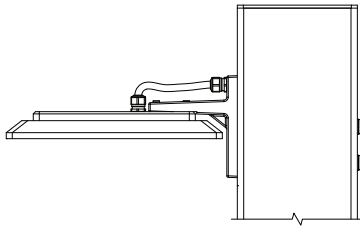
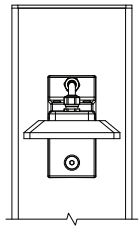

Adjustable Mounting (ADJ)

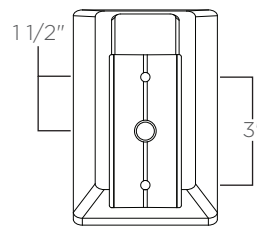
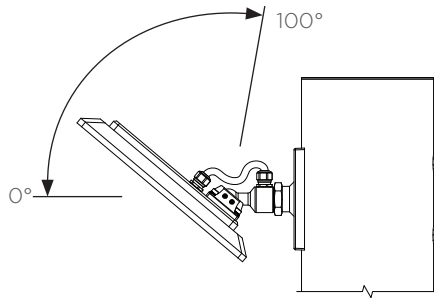
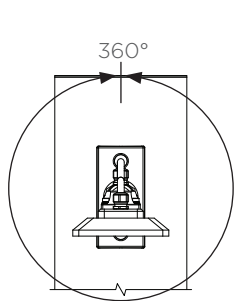

Catenary Mounting Standalone Entry (CAT/S)

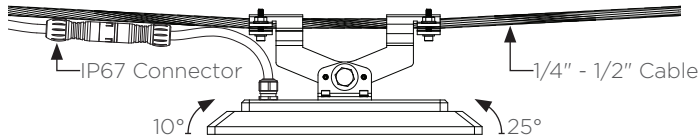

Daisy Chain Setup (CAT/D)

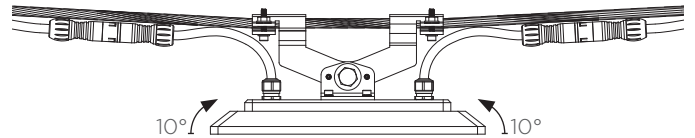

Junction Box Mounting 4" Octagonal Box (J/RND)

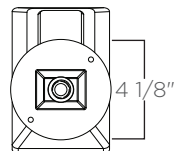
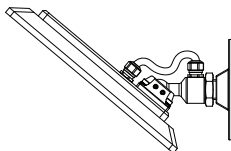
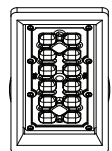

1-Gang Rectangular Box (J/RCT)

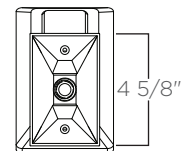
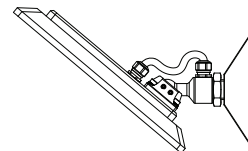
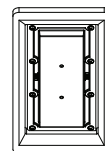

Type II Distribution

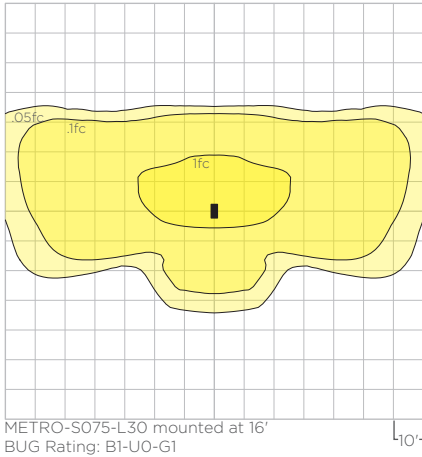

Type IV Distribution

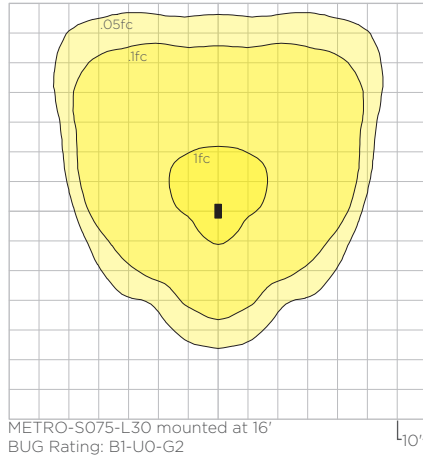

Type V Distribution

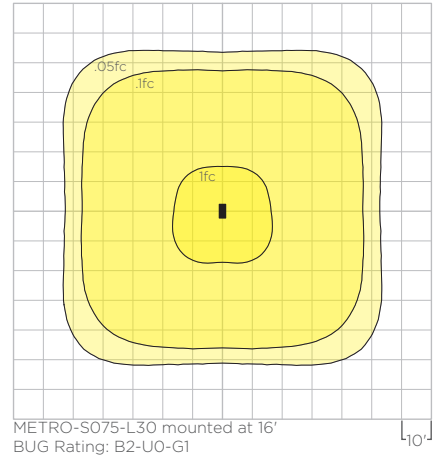

20° Spot Distribution

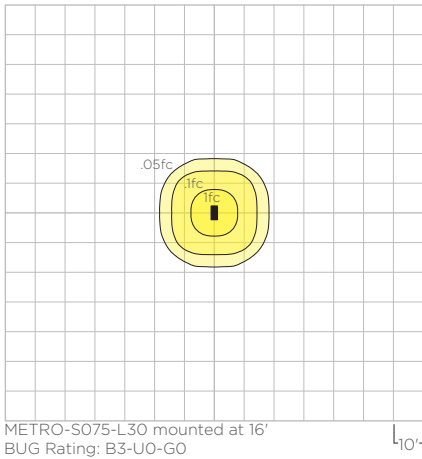

60° Spot Distribution

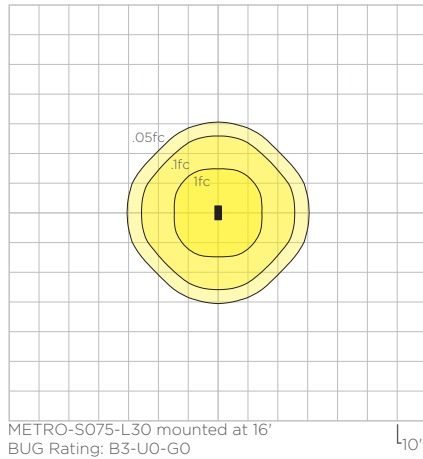

100° Spot Distribution

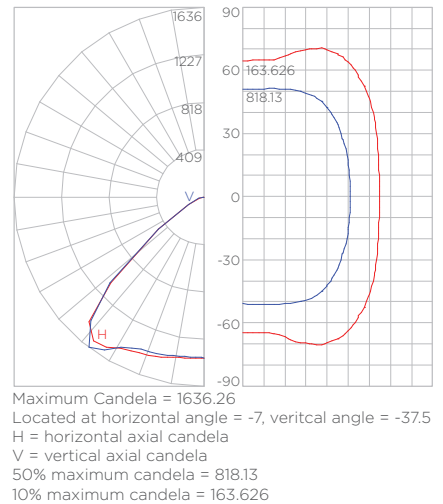
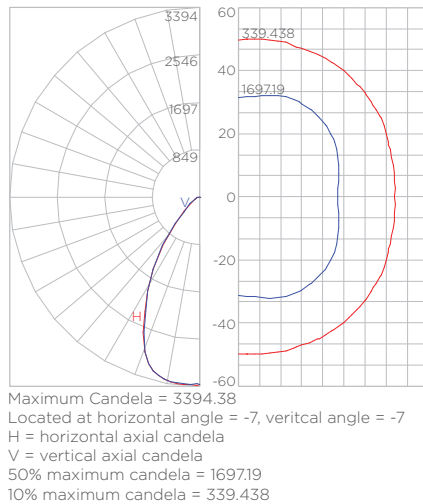
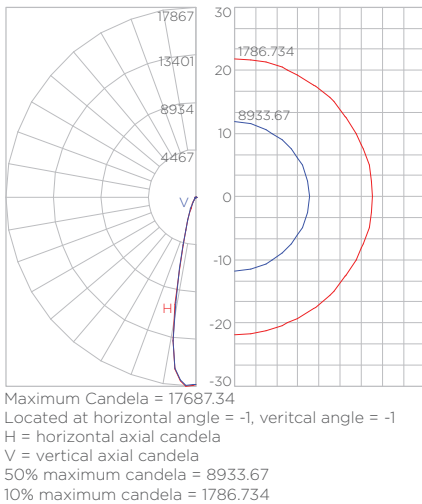
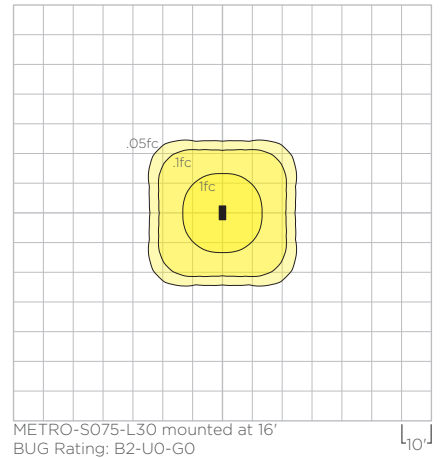

[IES file download](#)