

# Lineal Bollard

## Installation Instructions

STRUCTURA

### Warnings

CAUTION—risk of fire and this product must be installed in accordance with the applicable installation code by a person familiar with the construction and operation of the product and the hazards involved.

Suitable for wet locations.

Mounting orientation must have light source facing down.

Electrical service must be disconnected during installation.

Proper grounding is required to protect against shock and proper operation.

### Tools Required

T20 Tamper-resistant drive

7/32" Allen wrench

Wiring tools and connectors

### Bollard Installation

Step 1: Turn off power to location.

Step 2: Remove (1) 8-32 tamper-resistant torx screw from lower portion of accent panel as shown in Figure A.

Step 3: Slide accent panel upwards as shown in Figure B.

Step 4: Pull the bottom of the accent panel outwards as shown in Figure C to expose handhole and mounting hardware. Set safely aside.

Step 5: Remove (2) 3/8"-16 flat head socket cap bolts to release baseplate as shown in Figure D.

Step 6: Attach baseplate to pre-installed anchor bolt assembly according to footing detail (separate instructions). Re-secure bollard body to baseplate.

Step 7: Remove (2) 8-32 tamper-resistant torx screw from handhole cover in Figure F to expose driver compartment. Connect power to LED driver as shown on page 2 for driver wiring.

Step 8: Re-secure handhole cover and accent panel.

Step 9: Turn power back on.

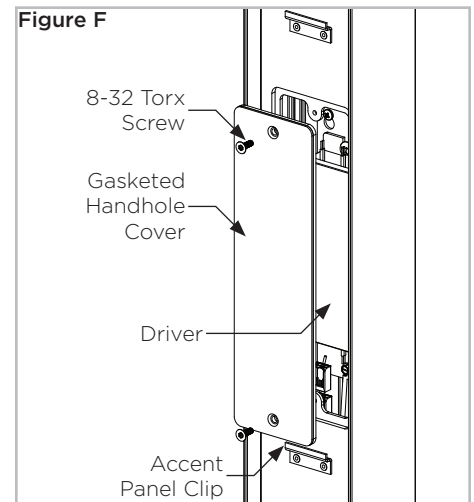
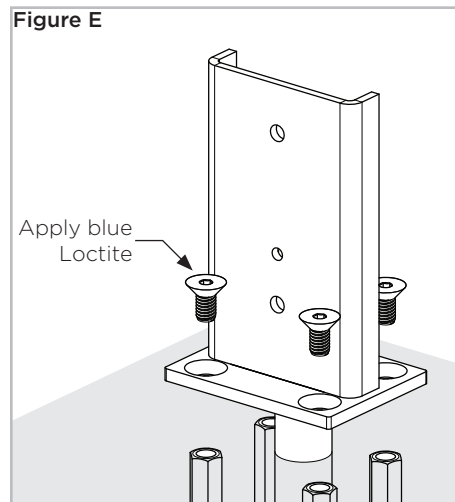
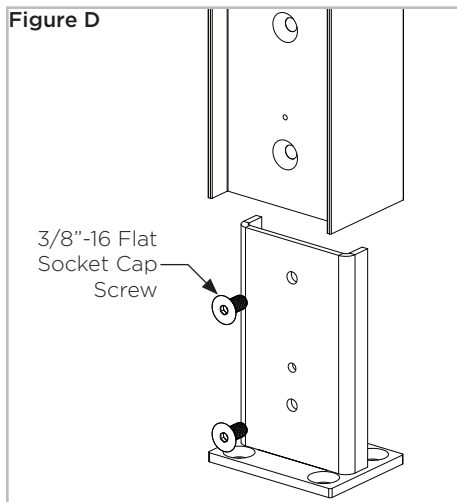
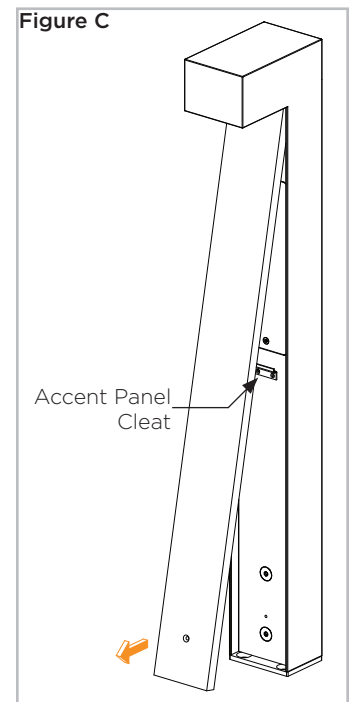
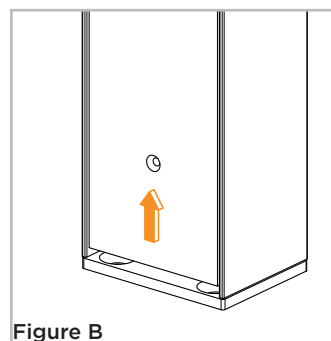
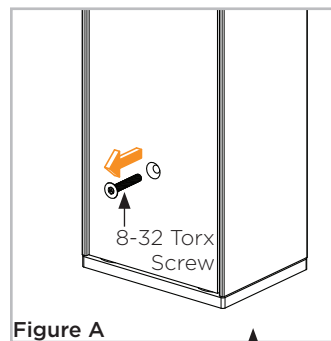
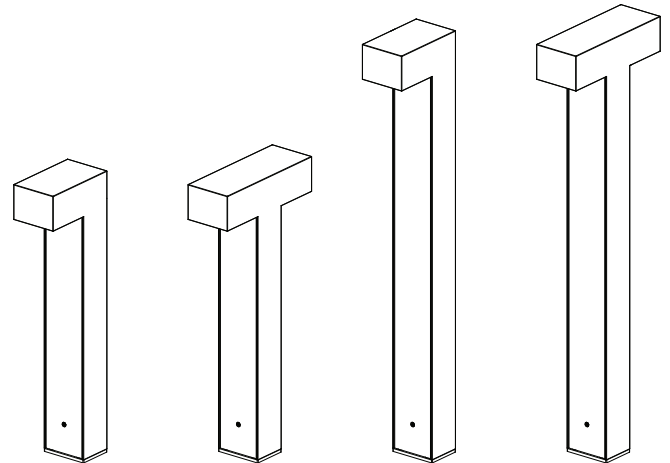

# Lineal Bollard

## Installation Instructions

### Bollard Wiring

Step 1: Connect input power to driver pigtail as shown below.

Step 2: Connect dimming wires to remote dimmer (by others) if applicable.

Step 3: Connect grounding wire to ground pigtail attached to driver box tray.

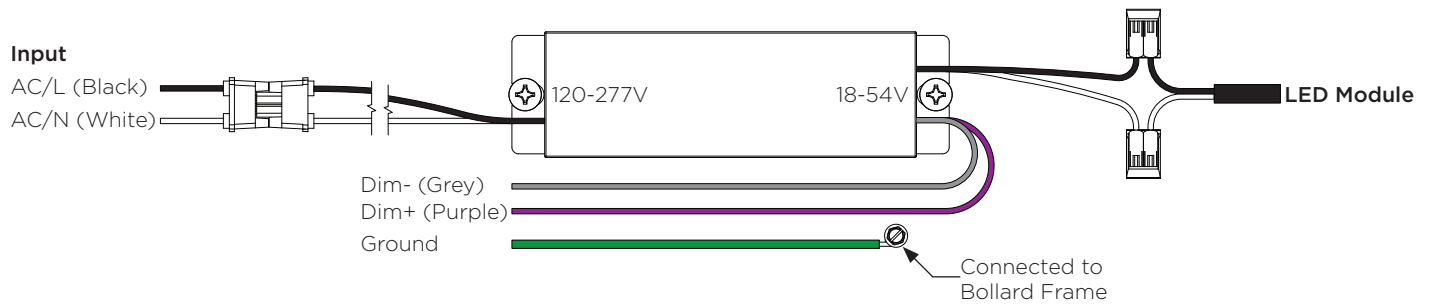

### Base Detail

