

4

3

2

1

D

D

C

C

B

B

A

A

1" to conduit

1'-5"

1/4" Gap to Bottom of Baseplate

3/8"-16 L-Anchor Bolt x 18" Galv

Foundation Design (By Others)

Conduit (By Others)

Baseplate with coupling nuts (pre-installed)

3"

5"

Baseplate with coupling nuts (pre-installed)

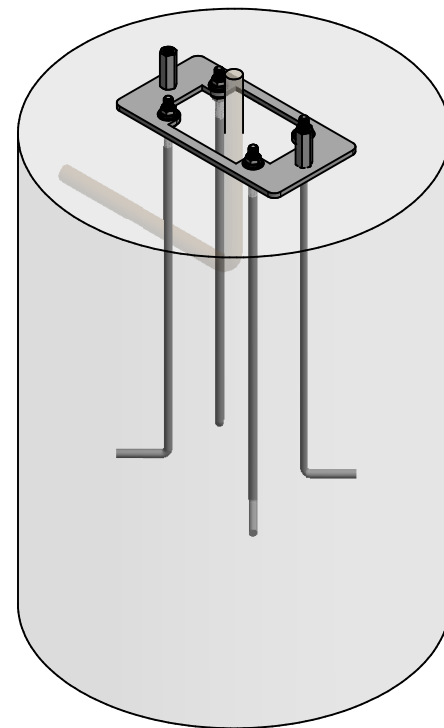

Use baseplate to install anchor bolts.
 Keep baseplate 1/4" off the top of the concrete.
 Slope concrete away from baseplate.

Typical Anchor Bolt Installation

STAMP

STRUCTURA

19922 W. 162nd Street phone 913.390.8787
 Olathe, KS 66062 projects@structura.com

Mac and Mac II Bollards

SHEET NUMBER
2 of 2

REVISED
Issue

DATE
3/29/2016

DRAWING
Generic.idw

4

3

2

1

A